

SENDAI ROYAL PARK HOTEL

Address | 6-2-1 Teraoka, Izumi-ku, Sendai

TEL:81-22-377-2100(9:00~18:00) FAX:81-22-377-1450

Access
 30 minutes by taxi from JR Sendai Station.
 15 minutes by taxi from Izumi-Chuo Subway Station or 20 minutes on the Miyagi Transportation Bus bound for Izumi Park Town, then 8 minutes walk.
 * The free shuttle bus for hotel guests departs from JR Sendai Station and Izumi-chuo Subway Station. (regular services and no reservations required)

E-mail | —

Available hours | 7:00~22:00

Reception desk hours | 9:00~17:30

Closed | The 3rd Thu. in Feb. and others.



Located in the center of Izumi Park Town surrounded by nature, this is a resort hotel conveniently situated near outlet malls, shopping, golf courses and sports facilities.



*Usage fees, capacity, number of seats, meal offerings, etc. are subject to change. Please check the facility website for details.

Convention Facilities

Name [Floor]	Area (㎡)	Capacity					Ceiling height (m)	Divisible	Internet	Dining/drinking	Approx. fee (9:00~17:00/excl. tax, incl. service charge)	Remarks
		Theater	School	Hollow Square Style	Dinner	Buffet						
Large Banquet Hall Royal Hall [Lobby floor]	755	800	560	100	420	550	7.5	Can be divided	Wifi/Free	○	220,000 yen/hr (Every day)	2 seated tables in a square shape
Medium Banquet Hall Crown Room [Garden floor]	312	350	190	56	150	200	3.5	Can be divided	Wifi/Free	○	110,000 yen/hr (Every day)	2 seated tables in a square shape
Small Banquet Room Utage [Garden floor]	148	110	70	36	50	100	3.4	Can be divided into 4	Wifi/Free	○	66,000 yen/hr (Every day)	2 seated tables in a square shape
Small Banquet Room Kasumi [Garden floor]	105	80	50	24	30	70	3.4	Can be divided	Wifi/Free	○	55,000 yen/hr (Every day)	2 seated tables in a square shape
Small Banquet Room Aya [Garden floor]	88	60	40	20	20	50	3.4	Can be divided	Wifi/Free	○	44,000 yen/hr (Every day)	2 seated tables in a square shape
Garden Banquet Mon Cheri [Garden floor]	180	80	60	36	80	100	3	×	Wifi/Free	○	88,000 yen/hr (Every day)	2 seated tables in a square shape
Exclusive Table [Garden floor]	107	50	20	22	30	50	2.8	×	Wifi/Free	○	77,000 yen/hr (Every day)	2 seated tables in a square shape

Room Facilities

Type	Rooms	Area (㎡)	Internet	Barrier-free	Remarks
Standard Double	12	23	Wired and wireless LAN	×	Forest side view
Standard Twin	28	23	Wired and wireless LAN	×	Forest side view
Standard Hollywood Twin	7	23	Wired and wireless LAN	×	Forest side view
Moderate Double	5	27	Wired and wireless LAN	×	Forest side view
Moderate Twin	5	27	Wired and wireless LAN	×	Garden side view
Luxury Double	2	36	Wired and wireless LAN	×	Garden side view
Luxury Twin	26	37	Wired and wireless LAN	×	Garden side view
Luxury Family Room	2	37	Wired and wireless LAN	×	Garden side view
Universal Room(Barrier-Free Twin)	1	37	Wired and wireless LAN	○	Garden side view
Deluxe View Bath Twin	8	42	Wired and wireless LAN	×	Garden side view
Junior Suite Double	3	46	Wired and wireless LAN	×	Garden side view
Terrace Junior Suite Twin	4	42	Wired and wireless LAN	×	Garden side view
Noble Suite	2	60	Wired and wireless LAN	×	Garden side view
Family Corner Suite	2	62	Wired and wireless LAN	×	Garden side view
Japanese Suite "Waso"(Japanese-style Room)	1	80	Wired and wireless LAN	×	Garden side view
Sky Terrace Suite	1	74	Wired and wireless LAN	×	Garden side view
Royal Suite	1	153	Wired and wireless LAN	×	Garden side view

Other Services

Parking	Language	Business center
220 vehicles (above ground) 35 vehicles, underground 71 vehicles, 114 vehicles extra) ※ free of charge	English	—
How to apply		Currency exchange
Phone/Website		USD/EUR (cash only)

Dining Facilities

Name	Kind	Seating Capacity
All-Day Dining Chef's Terrace	Western cuisine	96 seats inside + 24 terrace seats
Teppan-Yaki Nanatsumori	Teppanyaki	13 seats (counter)
Chinese Restaurant Keikaen	Chinese cuisine	121
Lobby Lounge Fontaine	Lounge	54

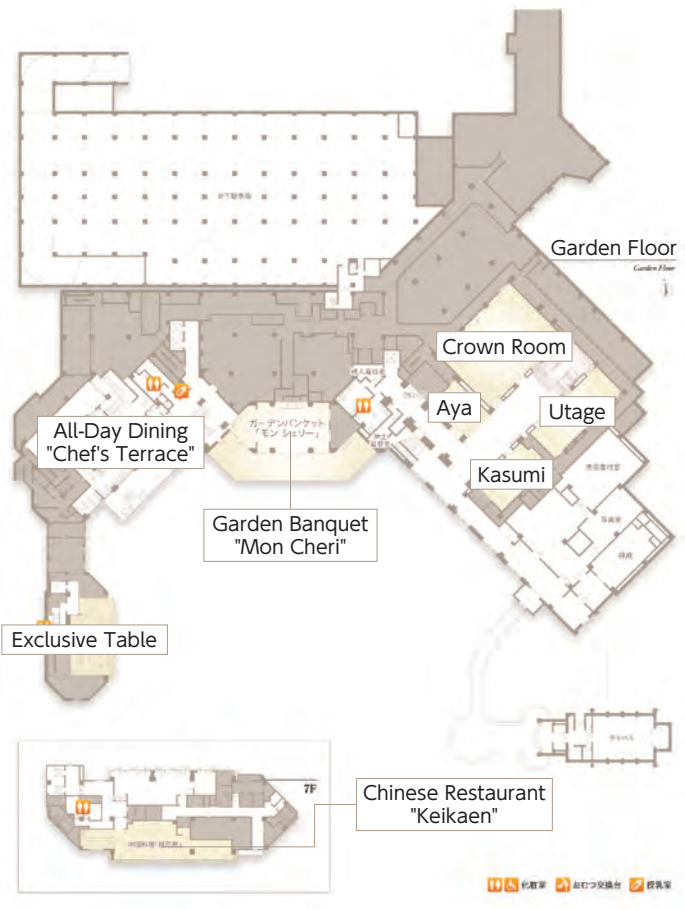

All-Day Dining Chef's Terrace



Exclusive Table

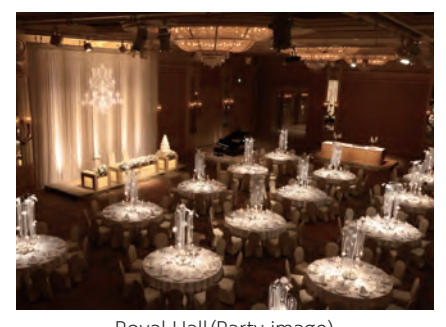

Royal Hall (Party image)



Garden Banquet "Mon Cheri"



Garden scene 1



Royal Hall (School style)



Garden scene 2