



TOHOKU UNIVERSITY KATAHIRA SAKURA HALL

Address | 2-1-1 Katahira, Aoba-ku Sendai
TEL : 81-22-217-4905 FAX : 81-22-217-5584

Access  A 15 minute walk from JR Sendai Station.
 A 10 minute walk from Aoba-dori Ichibancho Subway Station.

E-mail | sakurahall@grp.tohoku.ac.jp

Available hours | 8:00~20:00

Reception desk hours | 8:30~17:15 (Closed on Sat. Sun. and public holidays, the end of year and new year holidays and summer holidays.)

Closed | 29 Dec. to 3 Jan. and occasionally for maintenance.



Complete with screen and projector. Poster boards and other equipment available to be borrowed. Those other than university staff may use the hall for the purposes of academic and cultural improvement. (Main use: academic societies, lectures, training etc.)



*Usage fees, capacity, number of seats, meal offerings, etc. are subject to change. Please check the facility website for details.

Convention Facilities

Name [Floor]	Area (㎡)	Capacity					Ceiling height (m)	Divisible	Internet	Dining/drinking	Approx. fee (9:00~17:00 /incl. tax)	Remarks
		Theater	School	Hollow Square Style	Dinner	Buffet						
1st Fl. Lounge	178	-	-	-	-	-	-	×	Wireless LAN/Free (eduroam) Wired LAN/ Free (Only for Tohoku Univ. members)	○	4,940 yen/hr (Every day)	-
2nd Fl. Meeting Room	206	196	156	-	-	-	-	Can be divided into 3	Wireless LAN/Free (eduroam) Wired LAN/ Free (Only for Tohoku Univ. members)	×	5,390 yen/hr (Every day)	-

Other Services

Parking	Language	Business center	Barrier-free	How to apply	Application Period	Advance Reservations
Max.40 vehicles (Fees charged. Available only on Saturdays, Sundays, and holidays)	×	-	Wheelchair compatible toilet	phone*	From 1 year to 10 days before the date of use as a general rule.	In some cases, such as an international conference where it is deemed necessary to secure the venue as soon as possible for preparation, it is possible to make earlier reservations.

*After making a tentative reservation by phone or email, submit the application of use form in person.



1st Fl. Lounge



2nd Fl. Meeting Room

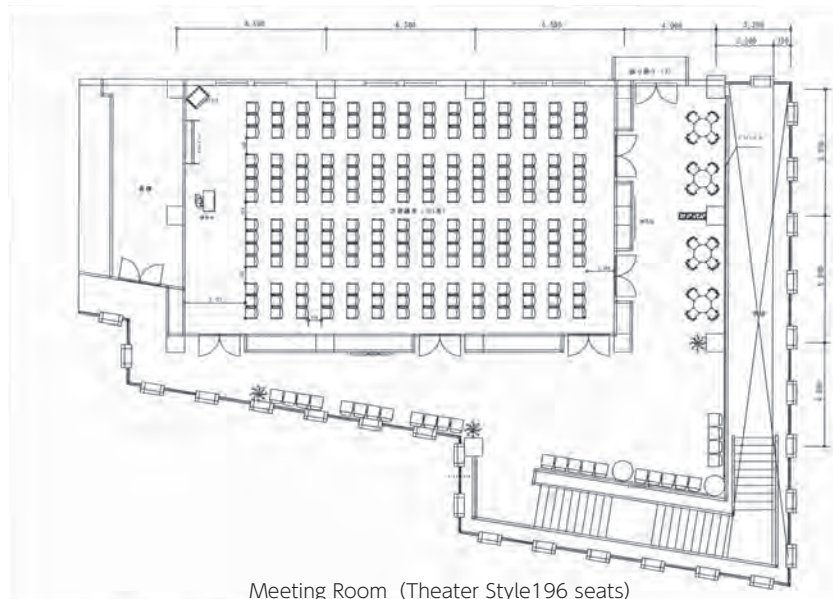

Meeting Room (Theater Style 196 seats)

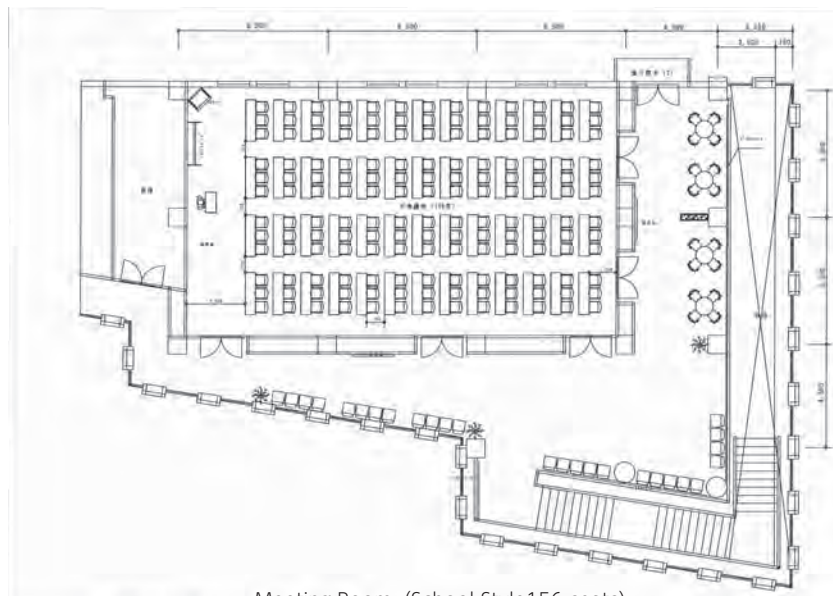

Meeting Room (School Style 156 seats)