

SENDAI ROYAL PARK HOTEL

Address | 6-2-1 Teraoka, Izumi-ku, Sendai
 TEL:81-22-377-2100(9:00~18:00) FAX:81-22-377-2221

Access
 30 minutes by taxi from JR Sendai Station.
 15 minutes from Izumi-Chuo Subway Station or
 20 minutes on the Miyagi Transportation Bus
 bound for Izumi Park Town, then 8 minutes walk
 * A free shuttle bus operates between
 JR Sendai Station and Izumi-chuo
 Subway Station (regular services
 and no reservations required)

E-mail | —
 Available hours | 7:00~22:00
 Reception desk hours | 9:00~18:00
 Closed | The 3rd Tue. in Feb. and
 others.



Located in the center of Izumi Park Town surrounded by nature, this is a resort hotel conveniently situated near outlet malls, shopping, golf courses and sports facilities.



Convention Facilities

Name	Floor (:m)	Capacity					Ceiling height (:m)	Divisible	Internet	Dining/drinking	Approx. fee (9:00 ~ 17:00/excl. tax, incl. service charge)	Remarks
		Theater	School	Hollow Square Style	Dinner	Buffet						
Royal Hall	755	800	570	100	450	700	7.0	Can be divided	Wifi/Free	○	198,000 yen/hr (Every day)	2 seated tables in a square shape
Crown Room	312	350	200	56	180	250	3.4	Can be divided	Wifi/Free	○	99,000 yen/hr (Every day)	2 seated tables in a square shape
Utage	148	110	70	36	50	100	3.4	Can be divided into 4	Wifi/Free	○	55,000 yen/hr (Every day)	2 seated tables in a square shape
Kasumi	105	80	50	24	40	70	3.4	Can be divided	Wifi/Free	○	44,000 yen/hr (Every day)	2 seated tables in a square shape
Aya	88	60	40	20	30	50	3.4	Can be divided	Wifi/Free	○	33,000 yen/hr (Every day)	2 seated tables in a square shape
Garden Banquet Mon Cheri	180	80	60	36	80	100	3.0	×	Wifi/Free	○	66,000 yen/hr (Every day)	2 seated tables in a square shape
Sky Banquet Tiara	170	50	35	16	30	40	2.7	×	Wifi/Free	○	55,000 yen/hr (Every day)	2 seated tables in a square shape
Exclusive Table	107	50	30	22	30	50	2.8	×	LAN/Free	○	66,000 yen/hr (Every day)	2 seated tables in a square shape

Room Facilities

Type	Rooms	Floor (:m)	Internet	Barrier-free	Remarks
STANDARD DOUBLE	12	23	Wired and wireless LAN	×	Forest side view
STANDARD TWIN	35	23	Wired and wireless LAN	×	Forest side view
MODERATE DOUBLE	5	27	Wired and wireless LAN	×	Forest side view
GARDENSIDE COMFORT TWIN	5	27	Wired and wireless LAN	×	Garden side view
GARDENSIDE LUXURY TWIN	30	34~37	Wired and wireless LAN	×	Garden side view
BARRIER-FREE ROOM	1	37	Wired and wireless LAN	○	Garden side view
JUNIOR SUITE DOUBLE	3	46	Wired and wireless LAN	×	Forest side view
DELUX SUITE	4	40	Wired and wireless LAN	×	Garden side view
PREMIUM VIEW BATH TWIN	8	40	Wired and wireless LAN	×	Garden side view
EXECUTIVE SUITE DOUBLE	2	60	Wired and wireless LAN	×	Garden side view
EXECUTIVE SUITE TWIN	2	62	Wired and wireless LAN	×	Garden side view
JAPANESE SUITE (JAPANESE STYLE ROOM)	1	80	Wired and wireless LAN	×	Garden side view
PRESEDENTIAL SUITE (TWIN)	1	74	Wired and wireless LAN	×	Garden side view
ROYAL SUITE (DOUBLE)	1	153	Wired and wireless LAN	×	Garden side view

Other Service

Parking	Language	Business center
220 vehicles (above ground 35 vehicles, underground 71 vehicles, 114 vehicles extra)	English	—
How to apply	Currency exchange	
Phone/Website	USD/EUR (cash only)	

Dining Facilities

Name	Kind	Seating Capacity
GARDEN RESTAURANT "CHEF'S TERRACE"	Western cuisine	78
TEPPAN-YAKI "NANATSUMORI"	Teppanyaki	13
CHINESE RESTAURANT "KEI-KA-EN"	Chinese cuisine	54
LOBBY LOUNGE "FONTAINE"	Lounge	54

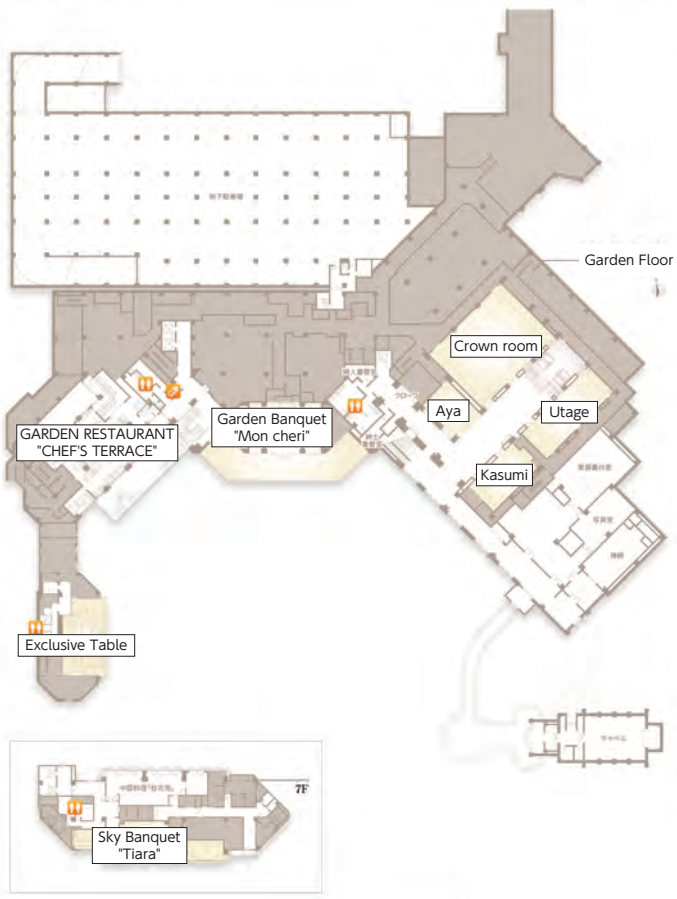

Garden Restaurant "CHEF'S TERRACE"



Exclusive Table



Lobby



Garden Banquet Mon Cheri



Utage



Royal Hall (party)



Kasumi



Royal Hall (school)