

SENDAI INTERNATIONAL CENTER

Address | Aobayama, Aoba-ku, Sendai
 TEL : 81-22-265-2211 FAX : 81-22-265-2485

Access | 🚗 7 minutes by taxi from JR Sendai Station (approx. 2 km).
 🚶 1 minute walk from International Center Subway Station.

E-mail | info@aobayama.jp

Available hours | 9:00~21:30

Reception desk hours | 9:00~20:00

Closed | Irregular



Sendai International Center is a base for conventions and academic culture promotion of the City of Trees Sendai. It includes a conference bldg. with a main hall with a capacity of 1,000 people, large and small conference rooms, and an exhibition bldg. with 3,000 m² exhibition space. It is possible to host events for approx. 6,000 people when using both bldgs. together. With its natural environment such as Aobayama and Hirose River, and academic culture facilities such as Sendai City Museum, Miyagi Prefectural Art Museum and Tohoku University in the area a new type of convention can be experienced.



Conference Bldg.

Convention Facilities

	Name	Floor (m)	Capacity					Ceiling height (m)	Divisible	Internet	Dining/drinking	Approx. fee (9:00 ~ 17:00 /incl. tax)	Remarks
			Theater	School	Hollow Square Style	Dinner	Buffet						
Conference Bldg.	Main Hall	1,150	1,000	-	-	-	-	-	×	Wifi/Free	×	174,000 yen/8hrs (Sat./Sun.)	300 inch screen
	Tachibana Conference Hall	463	500	288	-	-	-	4.8	×	Wifi/Free	○	169,400 yen/8hrs (Sat./Sun.)	200 inch screen
	Hagi Conference Hall	379	400	225	-	-	-	4.8	×	Wifi/Free	○	158,900 yen/8hrs (Sat./Sun.)	200 inch screen
	Shirakashi Conference Room (whole)	366	400	234	72	-	-	4.0	Can be divided	Wifi/Free	○	141,400 yen/8hrs (Sat./Sun.)	-
	Shirakashi Conference Room 1	240	220	126	60	-	-	4.0	×	Wifi/Free	○	88,900 yen/8hrs (Sat./Sun.)	-
	Shirakashi Conference Room 2	110	110	72	48	-	-	4.0	×	Wifi/Free	○	52,500 yen/8hrs (Sat./Sun.)	-
	Meeting Room 1	91	96	54	42	-	-	2.9	×	Wifi/Free	○	46,400 yen/8hrs (Sat./Sun.)	-
	Meeting Room 2	93	96	54	42	-	-	2.9	×	Wifi/Free	○	46,400 yen/8hrs (Sat./Sun.)	-
	Meeting Room 3	53	42	24	30	-	-	2.5	×	Wifi/Free	○	27,000 yen/8hrs (Sat./Sun.)	-
	Meeting Room 4	65	56	36	36	-	-	2.6	×	Wifi/Free	○	32,400 yen/8hrs (Sat./Sun.)	-
	Meeting Room 5	65	56	36	36	-	-	2.6	×	Wifi/Free	○	32,400 yen/8hrs (Sat./Sun.)	-
	Meeting Room 6	62	56	36	36	-	-	2.6	×	Wifi/Free	○	32,400 yen/8hrs (Sat./Sun.)	-
	Meeting Room 7	62	56	36	36	-	-	2.6	×	Wifi/Free	○	32,400 yen/8hrs (Sat./Sun.)	-
	Meeting Room 8	86	100	63	42	-	-	2.6	×	Wifi/Free	○	44,500 yen/8hrs (Sat./Sun.)	-
	Sakura Hall	755	800	450	132	370	400	6.8	Can be divided	Wifi/Free	○	24,600 yen/hr (Sat./Sun.)	200 inch screen
	Sakura Hall 1	459	312	200	96	190	250	6.8	×	Wifi/Free	○	15,000 yen/hr (Sat./Sun.)	200 inch screen
	Sakura Hall 2	296	256	120	78	90	150	6.8	×	Wifi/Free	○	9,600 yen/hr (Sat./Sun.)	-
	Japanese Style Room	-	-	-	-	-	-	2.4	×	Wifi/Free	○	4,800 yen/hr (Sat./Sun.)	10 mats x 2 rooms
Waiting Room (10 rooms)	18 ~ 22	-	-	-	-	-	2.6	×	Wifi/Free	○	500 yen/hr (Sat./Sun.)	-	
Reception Room	45	-	-	-	-	-	2.6	×	Wifi/Free	○	1,000 yen/hr (Sat./Sun.)	-	
Special Reception Room	60	-	-	-	-	-	2.6	×	Wifi/Free	○	4,600 yen/hr (Sat./Sun.)	-	
Exhibition Bldg.	Exhibition Hall (Whole)	3,000	2,560	1,536	-	1,110	1,800	9	Can be divided into 5	Wifi/Free	○	97,500 yen/hr (Sat./Sun.)	-
	Exhibition Hall 1	1,000	792	480	-	380	600	9	Can be divided	Wifi/Free	○	32,500 yen/hr (Sat./Sun.)	-
	Exhibition Hall 1-A	500	224	150	-	-	-	9	×	Wifi/Free	○	-	-
	Exhibition Hall 1-B	500	230	150	-	-	-	9	×	Wifi/Free	○	-	-
	Exhibition Hall 2	1,000	792	480	-	370	600	9	×	Wifi/Free	○	32,500 yen/hr (Sat./Sun.)	-
	Exhibition Hall 3	1,000	792	480	-	380	600	9	Can be divided	Wifi/Free	○	32,500 yen/hr (Sat./Sun.)	-
	Exhibition Hall 3-A	420	180	102	-	-	-	9	×	Wifi/Free	○	-	-
	Exhibition Hall 3-B	580	348	162	-	-	-	9	×	Wifi/Free	○	-	-
	Meeting Room 1	200	168	108	66	-	-	4	×	Wifi/Free	○	79,000 yen/8hrs (Sat./Sun.)	Can be used with Meeting Room 2
	Meeting Room 2	200	168	108	66	-	-	4	×	Wifi/Free	○	79,000 yen/8hrs (Sat./Sun.)	Can be used with Meeting Room 1
	Meeting Room 3	200	182	99	60	-	-	3.7	Can be divided	Wifi/Free	○	79,500 yen/8hrs (Sat./Sun.)	-
	Meeting Room 3-A	100	70	48	42	-	-	3.7	×	Wifi/Free	○	48,700 yen/8hrs (Sat./Sun.)	-
	Meeting Room 3-B	100	70	48	42	-	-	3.7	×	Wifi/Free	○	48,700 yen/8hrs (Sat./Sun.)	-
	Meeting Room 4	200	182	99	60	-	-	3.7	Can be divided	Wifi/Free	○	79,500 yen/8hrs (Sat./Sun.)	-
	Meeting Room 4-A	100	70	48	42	-	-	3.7	×	Wifi/Free	○	48,700 yen/8hrs (Sat./Sun.)	-
	Meeting Room 4-B	100	70	48	42	-	-	3.7	×	Wifi/Free	○	48,700 yen/8hrs (Sat./Sun.)	-
	Reception Room 1	47	-	-	-	-	-	3	×	Wifi/Free	○	22,400 yen/8hrs (Sat./Sun.)	-
	Reception Room 2	47	-	-	-	-	-	3	×	Wifi/Free	○	22,400 yen/8hrs (Sat./Sun.)	-
Waiting Room	20~24	-	-	12	-	-	3	×	Wifi/Free	○	500 yen/hr (Sat./Sun.)	-	

Other Service

Parking	Language	Business center	Barrier-free
464 vehicles*	English	Photocopier/Printer	Elevator/Braille signs/Guiding blocks/toilet etc.
* 96 underground parking and 368 vehicles at Sendai Aobayama community Square (incl. space for 22 large buses)			
How to apply		Advance Reservations	
In person		As necessary for international and national academic conferences.	



Tachibana Conference Hall

Dining Facilities

Name	Kind	Seating Capacity
Café Leaf	Light Refreshments	84/12 at the Hip bar



Main Hall

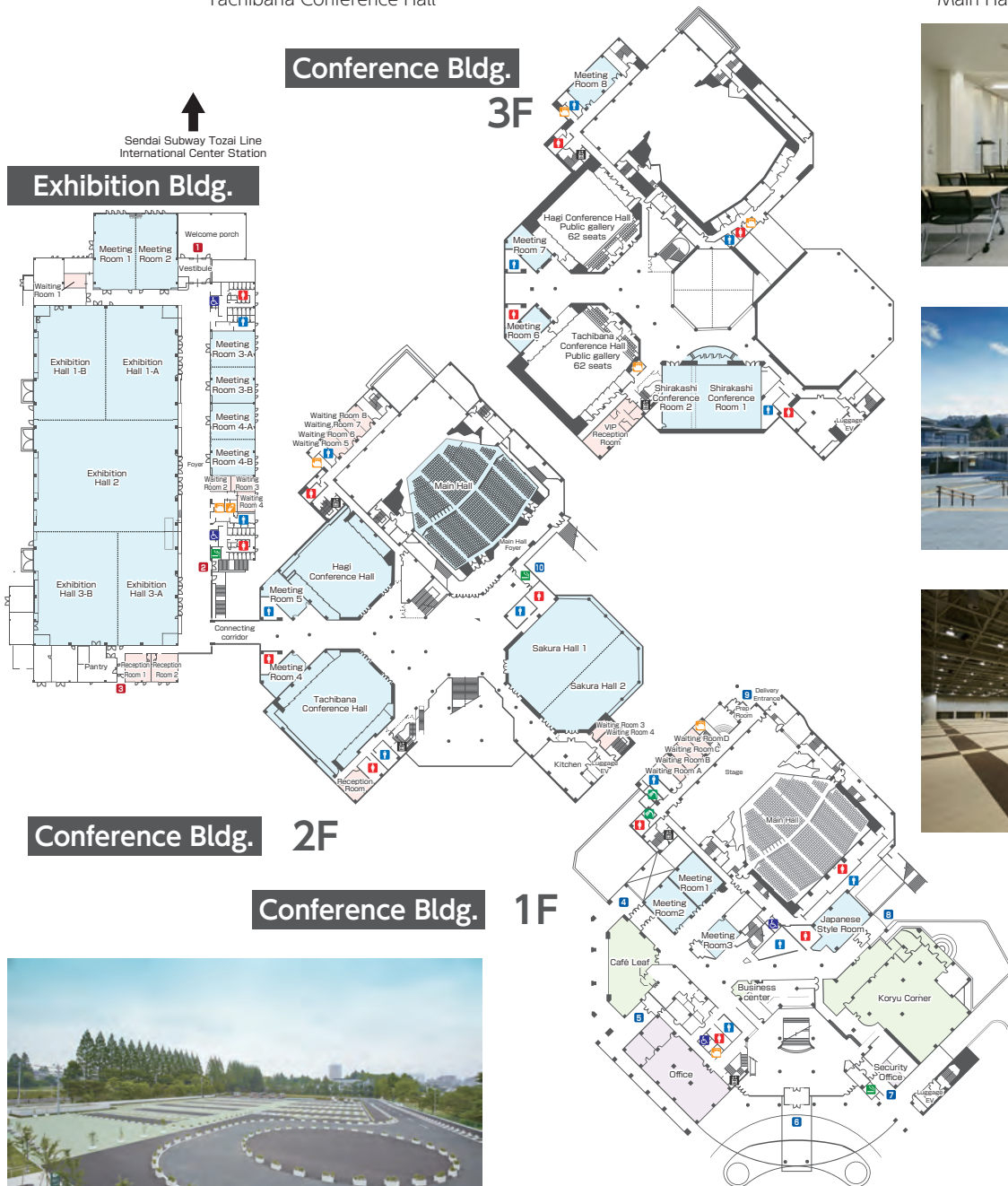

↑
Sendai Subway Tozai Line
International Center Station

Exhibition Bldg.

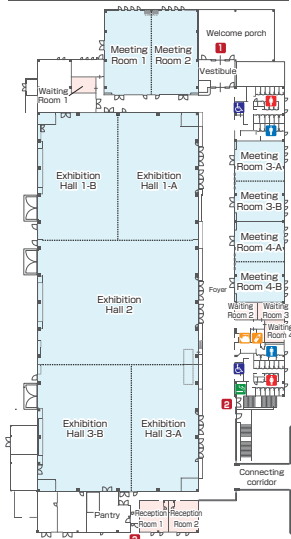

Conference Bldg. 2F

Conference Bldg. 1F

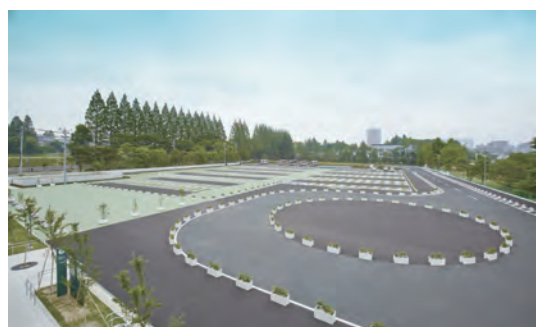

Sendai Aobayama Community Square



Meeting Room 3



Exhibition Bldg.



Exhibition Hall

Public facilities (Sendai City)

Public facilities (Sendai Suburbs)

Private Convention Facilities

Hotels

Hot Springs and Resorts